

STAINLESS METAL CRAFT

6 BROMLEY ROAD EMU PLAINS 2750
PHONE: (02) 4735 5666 FAX: (02) 4735 7950
E-MAIL info@smcstainless.com.au
www.smcstainless.com.au

THE STAINLESS STEEL PEOPLE

(SINCE 1962)

MATERIAL - GRADE 304 STAINLESS STEEL

GRATED CELL DRAIN

OPTIONS

- * VINYL CLAMP
- * MARINE GRADE 316
- * OUTLET LEFT RIGHT OR CENTRE



* TYPICAL USE :

-- POLICE STATIONS, GAOLS, JUVENILE JUSTICE CENTRES, COURT HOUSES,
IMMIGRATION CENTRES, PSYCHIATRIC HOSPITALS, SHIPS.

**DATA
SHEET**

ITEM: GRATED CELL DRAIN

CODE: PBC-GCD-1

DATE:

MARCH - 2003

REV:

C

PAGE No:

190

STAINLESS METAL CRAFT

6 BROMLEY ROAD EMU PLAINS 2750
 PHONE: (02) 4735 5666 FAX: (02) 4735 7950
 E-MAIL info@smcstainless.com.au
www.smcstainless.com.au

THE STAINLESS STEEL PEOPLE

(SINCE 1962)

MATERIAL - GRADE 304 STAINLESS STEEL

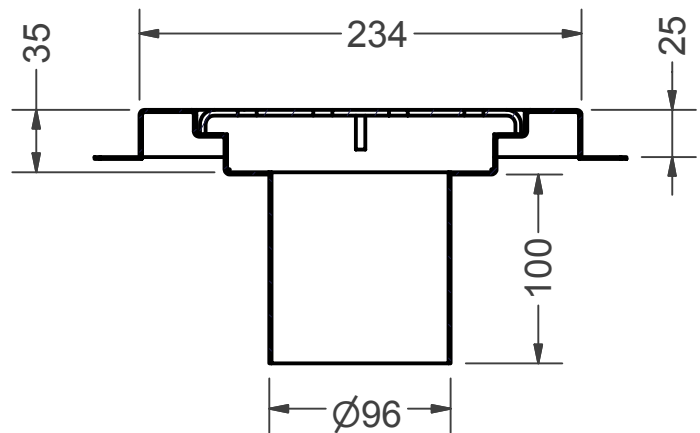
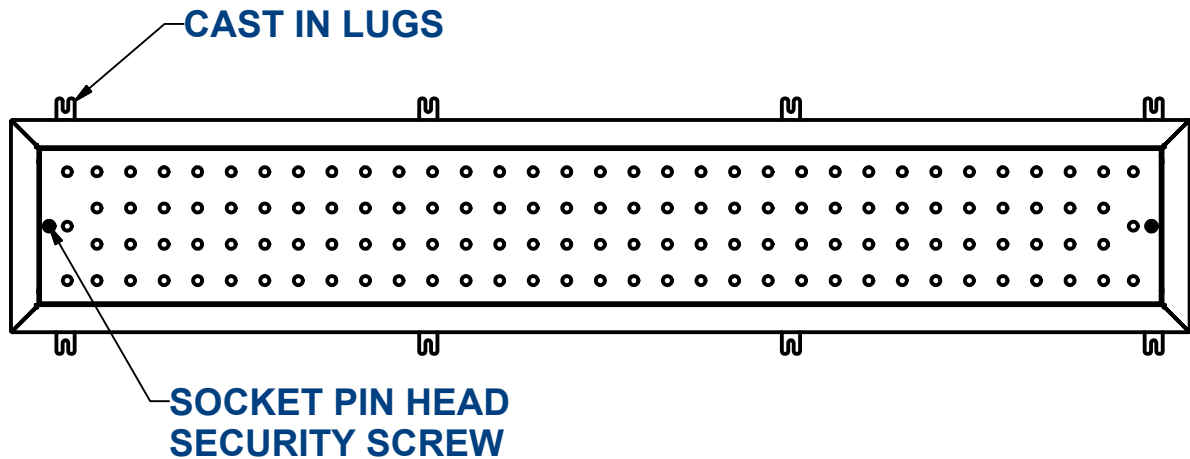

**SPECIFICATIONS -
 STAINLESS STEEL GRATED CELL DRAIN
 SHALL BE MODEL PCB-GCD-1 FROM
 STAINLESS METAL CRAFT
 PHONE: 02 4735 5666**

**DATA
 SHEET**

ITEM: GRATED CELL DRAIN

CODE: PBC-GCD-1

DATE:

MARCH - 2003

REV:

C

PAGE No:

190