

STAINLESS METAL CRAFT

6 BROMLEY ROAD EMU PLAINS 2750
PHONE: (02) 4735 5666 FAX: (02) 4735 7950
E-MAIL info@smcstainless.com.au
www.smcstainless.com.au

THE STAINLESS STEEL PEOPLE

(SINCE 1962)

MATERIAL - GRADE 304 STAINLESS STEEL

TRENCH GRATE SERIES 5

OPTIONS

- * MARINE GRADE 316
- * LOADING TO SUIT
- * ANGLE FRAME AVAILABLE
- * STAINLESS STEEL CHANNEL DRAIN LINING
- * LOCK DOWN DEVICE
- * CURVED SECTIONS

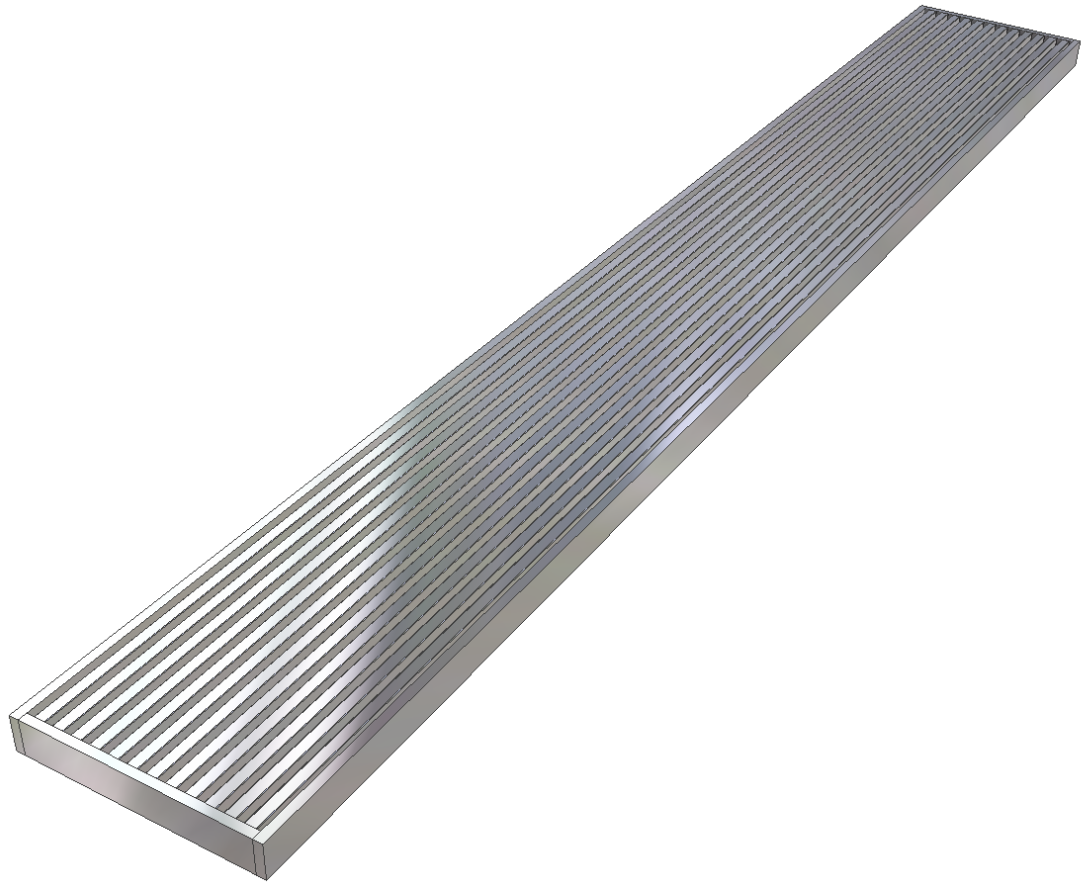

* TYPICAL USE -
-- FLOOR DRAINAGE

* BATHROOM - KITCHEN - GARAGE - BALCONY - ENTRY MAT - POOL

* SIZES OF FRAMES AND GRATES TO SUIT YOUR APPLICATION.

* SURFACE FINISH TO SUIT YOUR APPLICATION

* LOADING AS REQUIRED.

**DATA
SHEET**

ITEM: TRENCH GRATE

CODE: TG-5

DATE:

FEBRUARY - 2003

REV:

C

PAGE No:

8

STAINLESS METAL CRAFT

6 BROMLEY ROAD EMU PLAINS 2750
 PHONE: (02) 4735 5666 FAX: (02) 4735 7950
 E-MAIL info@smcstainless.com.au
www.smcstainless.com.au

THE STAINLESS STEEL PEOPLE

(SINCE 1962)

MATERIAL - GRADE 304 STAINLESS STEEL

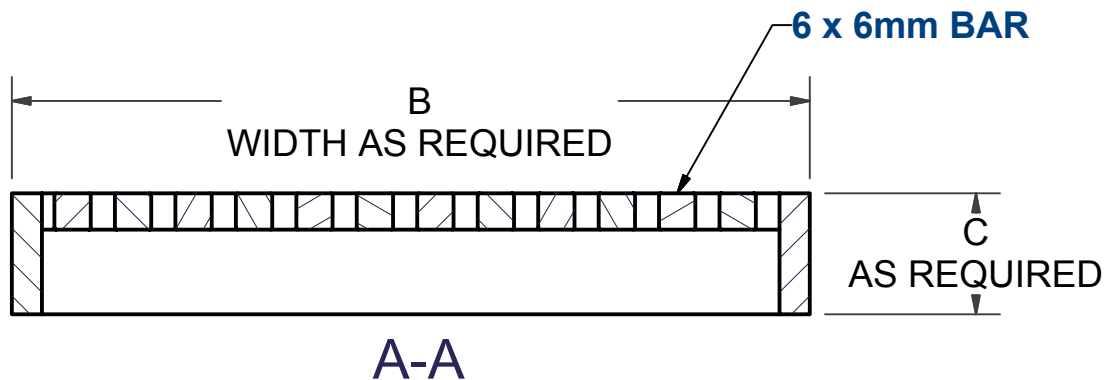
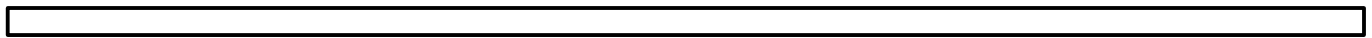

**SPECIFICATIONS -
 STAINLESS STEEL TRENCH GRATE
 SHALL BE MODEL TG-5 FROM
 STAINLESS METAL CRAFT
 PHONE: 02 4735 5666**

LOADING	
PEDESTRIAN	P/D
MEDIUM	M/D
HEAVY CLASS C	H/D

SIZE REQUIRED	
A	
B	
C	

DATA SHEET

ITEM: TRENCH GRATE

CODE: TG-5

DATE:
REV:

FEBRUARY - 2003

C PAGE No: 8